



TYCOON[®] XTend

XTended Safety & Stability

SAFETY & STABILITY WITHOUT COMPROMISE

In many cases, standard strapping technologies no longer live up to the increasing demands of heavy duty applications in the building, wood & timber, metal, and baling industries. By launching TYCOON® XTend, TEUFELBERGER introduces a strapping product into the market that offers enhanced functionality and high quality without compromising the safety and stability of packaging.

TYCOON® XTend – zero compromises!



XTended Tenacity

- ✓ Increased edge strength
- ✓ Split-free – improved splitting characteristics, even at lower ambient temperatures



XTended Shock Reserve

- ✓ The strap is capable of absorbing even extremely high shock loads
- ✓ Ideal combination of high strength and 16% elongation



XTended Weldability

- ✓ Higher welding joint strength, even at lower ambient temperatures
- ✓ Fewer outliers/drop-outs

TYCOON® XTend – better performance with identical dimensions!

The upgraded production technology, an improved raw material process, and, most of all, a new recipe including a **patented additive** form the basis for the new generation of TYCOON® XTend strapping products. A leap in performance in our new green.

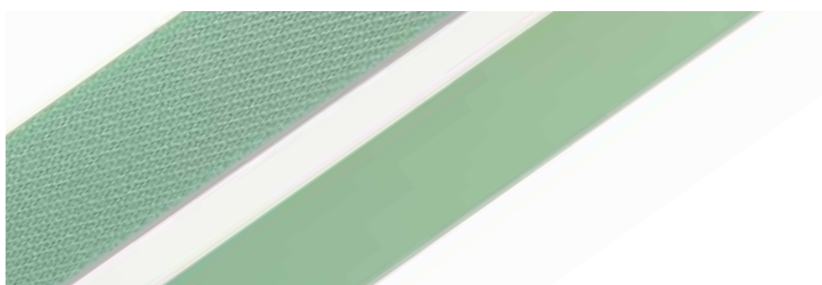

What is TYCOON® XTend best suited for?



Demanding heavy duty applications

- ✓ Typical fields of use: Wood & timber, building, metal, and baling industry
- ✓ As well as for all other applications where heavy goods need to be transported safely

Your benefit:

- ✓ Transporting goods in a compact and safe manner, without being damaged



Steel strap replacement

- ✓ Specially developed & improved heavy duty strap profile
- ✓ Complete portfolio of 16-32mm (5/8-1 1/4") straps

Your benefit:

- ✓ Reliable steel strap replacement with a clear cost advantage



Packaging optimization

- ✓ Use of less strapping per package/pallet, with strap dimensions remaining the same - e.g.: 4 straps with a 25x1.0mm (1x0.040") XTend instead of 5 with a conventional 25x1.0mm (1x0.040")
- ✓ Enhanced performance allows the use of thinner straps - e.g.: 16x0.9mm (5/8x0.035") XTend instead of a conventional 16x1.0mm (5/8x0.040")

Your benefit:

- ✓ Packaging optimization without any compromise in the safety and stability of your packaging, paired with a clear cost advantage

TYCOON® XTend – product portfolio

Width	Thickness	Breaking strength	Surface	Core
16–32mm	0.8–1.5mm	500–1,800kg	smooth/embossed	406 x 150/190/250/300mm
5/8–1 1/4"	0.030–0.060"	1,100–4,000lbs	smooth/embossed	16 x 6/7.5/10/12"

NEW TYCOON® – Jumbo make-ups

Jumbo-H	Jumbo-V	SUPER Jumbo-V	MEGA Jumbo-V	ULTRA Jumbo-H
70kg/coil 150lbs/coil	70kg/coil 150lbs/coil	110kg/coil 240lbs/coil	150kg/coil 330lbs/coil	330kg/coil 725lbs/coil

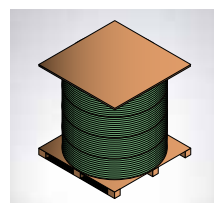
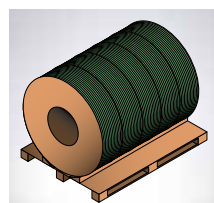
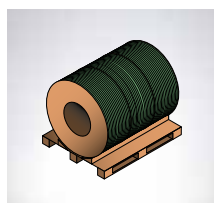
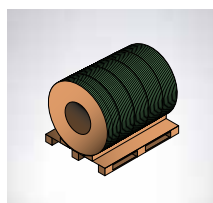
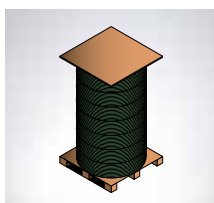

⚠ WARNING!

Using these products may prove dangerous. Never use our products for purposes other than those they were designed for. Customers shall ensure that all persons using these products are familiar with their correct use and the necessary safety precautions. Please bear in mind that any product can inflict damage or harm if used incorrectly or overloaded.

TEUFELBERGER®, 拖飞宝®, TYCOON® are internationally registered trademarks of the TEUFELBERGER Group. Subject to technical modifications, typesetting and printing errors.

TEUFELBERGER Ges.m.b.H.

Vogelweiderstraße 50
4600 Wels, Austria
Phone: +43 (0) 7242 413-0
Fax: +43 (0) 7242 413-91 120
fibersplastics@teufelberger.com

www.teufelberger.com